

**N<sup>PC</sup>** NATIONAL PUMP COMPANY  
A GORMAN-RUPP COMPANY

*The Pump People*

# VERTICAL TURBINE PUMPS

OIL & GAS  
INDUSTRIAL



PERFORMANCE

QUALITY

SERVICE

TRUST



Submersible  
VS0

- ▶ Off Shore Platform
- ▶ Seawater Lift
- ▶ Deep Well Dewatering
- ▶ Fire Protection

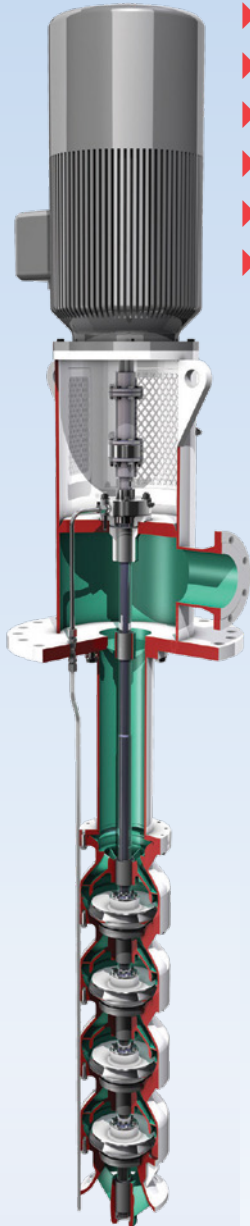

Wet Pit  
VS1

- ▶ Sump Type / Wet Pit
- ▶ Crude Oil Transfer
- ▶ Storm / Waste Water
- ▶ Secondary Recovery
- ▶ Cooling Water
- ▶ Aircraft Fueling

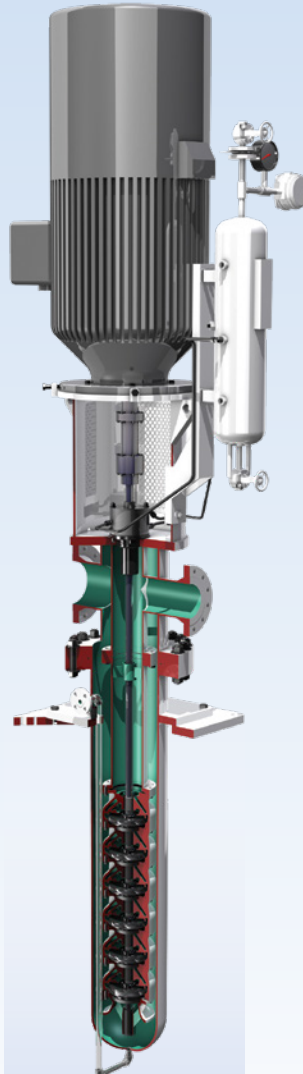

Canned Booster  
VS6

- ▶ Pipeline Booster
- ▶ Light Hydrocarbon,  
High-Vapor Pressure  
*(Low NPSHA)*
- ▶ LNG Transfer
- ▶ Refinery Service
- ▶ Vertical Process

## API 610 Compliant Designs

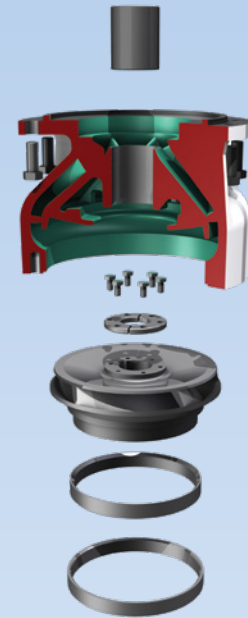

## Capabilities and Materials\*

National Pump Company is recognized as a dependable manufacturer of Vertical Turbine API 610 type pumps for the oil & gas and mining markets. Pumps can be manufactured in a variety of design and material configurations to suit your application, budget and timeline, for many years of dependable and efficient operation.

MATERIAL CLASS	BOWLS	IMPELLERS	BOWL WEAR RINGS	IMPELLER WEAR RINGS	SHAFTING	DISCHARGE HEAD/ SUCTION CAN	COLUMN BOWL SHAFT BUSHINGS	BOLTS
S-4	Carbon Steel	Carbon Steel	Cast Iron	Cast Iron	12% CR	Carbon Steel	Filled Carbon	Carbon Steel
S-5	Carbon Steel	Carbon Steel	12% CR Hardened	12% CR Hardened	12% CR	Carbon Steel	Filled Carbon	316 AUS
S-6	12% CR	12% CR	12% CR Hardened	12% CR Hardened	12% CR	Carbon Steel	Filled Carbon	316 AUS
S-8	316 AUS	316 AUS	Hard-faced 316 AUS	Hard-faced 316 AUS	316 SS	Carbon Steel	Filled Carbon	316 AUS
S-9	Ni-Cu Alloy	Ni-Cu Alloy	Ni-Cu Alloy	Ni-Cu Alloy	Ni-Cu Alloy	Carbon Steel	Filled Carbon	Ni-Cu Alloy
C-6	12% CR	12% CR	12% CR Hardened	12% CR Hardened	12% CR	AUS	Filled Carbon	316 AUS
A-7	AUS	AUS	Hard-faced AUS	Hard-faced AUS	AUS	AUS	Filled Carbon	316 AUS
A-8	316 AUS	316 AUS	Hard-faced 316 AUS	Hard-faced 316 AUS	316 AUS	316 AUS	Filled Carbon	316 AUS
D-1	Duplex	Duplex	Hard-faced Duplex	Hard-faced Duplex	Duplex	Duplex	Filled Carbon	Duplex
D-2	Super Duplex	Super Duplex	Hard-faced Super Duplex	Hard-faced Super Duplex	Super Duplex	Super Duplex	Filled Carbon	Super Duplex

\* Materials are in compliance with API 610 12th Edition. Materials in compliance with earlier editions can be supplied at customer request.

Abbreviations are as follows:

SS – Stainless Steel; CR – Chrome Steel; AUS – Austenitic SS; Ni-Cu Alloy – Monel types; Duplex – Duplex SS; Super Duplex – Super Duplex SS



Delivering Vertical Turbine Pump  
Reliability, Quality and Service  
Since 1969



Certified to  
NSF/ANSI CAN 61  
& NSF/ANSI 372

*Creating Quality Pump Systems and Satisfied Customers*

Visit us on the web at: [www.nationalpumpcompany.com](http://www.nationalpumpcompany.com)

### ARIZONA (Main Office)

7706 N. 71st Ave. • Glendale, AZ 85303-1703  
(623) 979-3560 • Fax (623) 979-2177  
(800) 966-5240



### FLORIDA

195 E. 3rd Street • Zolfo Springs, FL 33890  
(863) 735-8222 • Fax (863) 735-8202  
(800) 994-3045

### TEXAS

4229 Adrian St., Lubbock, TX 79415  
(806) 745-5396 • Fax (806) 745-6668  
(800) 745-5393



*Proud member of American Petroleum Institute and these organizations:*

